

<b>SUBJECT:</b>	<b>PROPOSED PROVISION AND AMENDMENTS TO TRAFFIC ORDERS AT VARIOUS LOCATIONS WITHIN MONMOUTHSHIRE.</b>
<b>MEETING:</b>	<b>INDIVIDUAL CABINET MEMBER DECISION – COUNCILLOR CATRIN MABY</b>
<b>DATE:</b>	<b>30<sup>th</sup> NOVEMBER 2022</b>
<b>DIVISION/WARDS AFFECTED:</b>	<b>ALL</b>

## **1. PURPOSE:**

- 1.1 This report seeks Cabinet Member approval to proceed with a number of Traffic Orders in addition to variations to the car parking schedule around the County.
- 1.2 The Traffic Orders under consideration relate to:
- provision of motorcycle parking and permitting motorhomes to park at Abergavenny bus station;
  - a prohibition of driving on Frogmore Street and Lion Street in Abergavenny;
  - a number of variations to the off-street parking places and Schedule 2 (off street car parks – operational times and tariffs) sections of the consolidation order including:
    - the introduction of one newly constructed car park (Severn Tunnel Junction);
    - the inclusion of one existing car park into the car parking schedule (Rogiet Country Park Car Park);
    - the amendment of the description and charging schedule of the new Wyebridge Street Car Park (under construction);
    - to remove the overstay facility in all long stay Council owned car parks;
    - to introduce the enforcement of electric vehicle bay spaces and restrict waiting to 4 hours in these bays.

The proposed Orders were advertised in accordance with the Local Authorities Traffic Orders (Procedure) (England and Wales) Regulations 1996.

- 1.3 If significant unresolved objections arise from the consultation, a public inquiry can be held to reach a decision. However, in this instance, it is considered that a public inquiry is not required and it is recommended that all of the proposals proceed with the Traffic Orders made, as set out below.

## **2. RECOMMENDATIONS:**

- 2.1 It is recommended to not hold a public inquiry, and to proceed to approve and implement the proposed Orders:
- 2.1.1 The introduction of one newly constructed car park (Severn Tunnel Junction);
- 2.1.2 The inclusion of one existing car park into the car parking schedule (Rogiet Country Park Car Park);

- 2.1.3 The amendment of the description and charging schedule of the new Wyebridge Street Car Park (under construction);
- 2.1.4 Removal of the overstay facility in all long stay Council owned car parks;
- 2.1.5 The introduction of enforcement of electric vehicle bay spaces and restrict waiting to 4 hours in these bays;
- 2.1.6 Provision of motorcycle parking and permitting motorhomes to park at Abergavenny bus station;
- 2.1.7 Prohibition of driving on Frogmore Street and Lion Street in Abergavenny.

### **3. KEY ISSUES:**

#### **Car Parking**

- 3.1 Severn Tunnel Car Park, Rogiet – following the completion of construction of this car park (estimated December 2022) it is necessary to add the car park into Schedule 2 of the consolidation order in order to allow Civil Enforcement Officers to manage usage and to introduce charging of £3.00 per day. It is anticipated that the provision of this car park will lessen the impact of on street parking practices within the residential areas of Rogiet and provide additional parking for commuters as an alternative to using the M4 and M48 in accordance with the recommendations of the Burn Commission report into M4 relief road alternatives.
- 3.2 Rogiet Country Park Car Park, Rogiet – whilst this car park is an existing asset, it is anticipated that following the construction of the new Severn Tunnel Car Park, commuters using the nearby train station may decide to use Rogiet Country Park Car Park instead, which is currently free of charge. Therefore, in order to manage usage it is intended to add this car park into Schedule 2 of the Consolidation Order and introduce a parking fee for users. The first 3 hours will be free of charge with a £5.00 charge for the remainder of the day. This is intended to allow short stay users of the Country Park to park for free, but deter extended stays from commuters who should be using the station car parks.
- 3.3 Wyebridge Street Car Park, Monmouth – Whilst this car park is at the early stages of construction (anticipated for completion March 2023), it was previously included within Schedule 2 of the Consolidation Order under Wyebridge Car Park. The name will be amended to Wyebridge Street Car Park and the charging schedule updated to the current long stay charge, that being; £1.50 for the first 2 hours or part thereof, £1.90 for 3 hours or part thereof, £2.40 for 4 hours of part thereof, £4.80 for all day, £18.00 for 5 days, £21.50 for 6 days. Long Stay Car Park season permit at £430 per annum, £220 half year, £110 quarterly. These charges may be subject to future changes arising from wider consultation on fees and charges.
- 3.4 Overstay Penalty Payment, County Wide – Currently in all long stay off-street car parks in the County where a motorist exceeds the paid duration of stay they may receive a penalty charge notice. If the motorist returns to the vehicle they are currently permitted to purchase an overstay ticket at a cost of £6, providing this is within 1 hour of the expiry time of the pay and display ticket. This effectively cancels the penalty charge notice (PCN). However, there is very little evidence that this facility is being used and it causes complications with issued PCNs. We have recently introduced an alternative to purchasing a pay and display ticket via pay by phone. This system call alert the user that their ticket is due to expire and provides them with the opportunity to extend their stay at a lower cost and in a more convenient way, prior to their current ‘ticket’ expiring. This avoids the PCN being issued in the first place. Therefore, it is intended to remove the overstay facility from all car parks.
- 3.5 Abergavenny Bus Station, Abergavenny – Currently within the parking bays to the rear of the bus stands in Abergavenny Bus Station, caravans are permitted to park between the

hours of 8.00am and 6.00pm. There is no provision for motorhome parking within Abergavenny, therefore, it is proposed to add the provision of motorhome parking into Schedule 2 of the consolidation order. This will enhance the visitor attraction of Abergavenny and provide an appropriate place for motorhome visitors to park while visiting the town and supporting local businesses and attractions.

- 3.6 Electric Vehicle Charging Bays, County wide – recently MCC, via CCR/WG funding has introduced electric vehicle charging bays within a number of car parks across the County and has plans to expand this provision over coming years. In order to manage usage of these bays, it is necessary to introduce these bays into the Consolidation Order. Parking within these bays is currently free of charge for electric vehicles that are charging. However, the provisions within the Consolidation Order are not currently there to enable enforcement. This change will allow MCC Civil Enforcement Officers to enforce contraventions, such as, non electric vehicles being parked in the bays and electric vehicles being parked in a bay without charging. It is also intended to limit waiting in these bays to a maximum of 4 hours.

### **Traffic**

- 3.7 Prohibition of Driving, Frogmore Street and Lion Street, Abergavenny – a Traffic Order is needed to permanently formalise the existing car-free arrangements on Frogmore Street and Lion Street following the recent public realm improvements. The Order will continue the existing practice of prohibiting driving along Frogmore Street and part of Lion Street between 10.00am and 4.00pm and a prohibition of driving except for loading between 4.00pm and 10.00am Monday to Sunday. Monmouthshire County Council has undertaken works within Frogmore Street to alter the highway layout and to enhance the urban street scene experience for pedestrians and other highway users. The proposed traffic order will continue to support the successful traffic free environment for visitors and residents and will also allow MCC to issue pavement café licences where appropriate.
- 3.8 Motorcycle Only Parking Area, Bus Station Car Park, Abergavenny – MCC has recently undertaken engineering works within the Bus Station and amended the bus station layout. The existing motorcycle parking bay was reduced in capacity due to the locating of a Hydrogen Refuelling Station, resulting in a lack of provision for motorcyclists. In order to remedy this, it is proposed to provide a formalised area for motorcycles to park within the revised bus station layout via a dedicated motorcycle only parking area in the vicinity of the Oasis Café which is a recognised meeting place for motorcyclists.

### **Conclusion**

- 3.9 A summary of consultation responses can be found in Appendix 1 together with Officer responses. There are no issues or comments raised that cannot be overcome or that change the Officer recommendation to proceed with introducing the proposed restrictions or amendments.

## **4. EQUALITY AND FUTURE GENERATIONS EVALUATION (INCLUDES SOCIAL JUSTICE, SAFEGUARDING AND CORPORATE PARENTING):**

- 4.1 The proposals aim to support the management of the Council's off street parking provision, and provide a traffic free environment in Abergavenny town centre. The proposal will also formalise current motorcycle parking practices within Abergavenny bus station.

## **5. OPTIONS APPRAISAL**

- 5.1 Table One below therefore provides an options appraisal of the proposal:

Options	Benefits	Risks	Comments/Mitigation
Do Nothing	<ul style="list-style-type: none"> <li>Less demand on officer time and resource/budget</li> </ul>	<ul style="list-style-type: none"> <li>Loss of income from car parks.</li> <li>Increase in extended duration of parking in the car parks</li> <li>The use of designated electric vehicle parking bays by non electric vehicles for extended periods of time.</li> <li>Motorcycles parking in areas not designated for that purpose.</li> </ul>	The benefits of taking action outweigh the resource implications.
Adopt the proposals	<ul style="list-style-type: none"> <li>Ensure the proposals are introduced as planned.</li> <li>Maximise income from off street car parks.</li> <li>Ensure inappropriate parking practices are kept to a minimum</li> <li>Provide a traffic free environment for visitors in Abergavenny town.</li> </ul>	<ul style="list-style-type: none"> <li>None</li> </ul>	This is the preferred option.

**6. REASONS:**

6.1 The proposals will support the management of the Council’s off-street parking provision, and provide a traffic free environment in Abergavenny town centre. The proposal will also formalise current motorcycle parking practices within Abergavenny bus station.

**7. RESOURCE IMPLICATIONS:**

7.1 The proposals will be funded from the Council’s Road Safety and Traffic Management budget.

**8. CONSULTEES:**

- Cabinet Member for Climate Change and the Environment
- Communities and Place DMT
- SLT including Monitoring Officer and S151 Finance Officer
- The Traffic Orders were publicised in accordance with the statutory process including notification of County Councillors for the affected wards and the relevant Town/Community Council.

**9. BACKGROUND PAPERS:**

- Appendix 1; Schedule of consultation responses
- Appendix 2: Notice of Intention
- Appendix 3: Statement of Reasons
- Appendix 4: Drawing no’s 1958, 1953, 1952
- Appendix 5: Wellbeing of Future Generations Equalities Impact Assessment

**10. AUTHORS:**

Mark Hand, Head of Placemaking, Highways and Flooding  
Graham Kinsella, Traffic and Road Safety Manager

**11. CONTACT DETAILS:**

**E-mail:** [markhand@monmouthshire.gov.uk](mailto:markhand@monmouthshire.gov.uk)

## Appendix 1: Summary of Consultation Responses

Name/Details	Representations	Officer's Response
<p>Resident 1 (objection via email)</p>	<p>1. The consultation documents online do not include (as required by law) the order being amended.</p> <p>It's true that the consolidation order is "available" on the website but only in its original form and there is no link from the pages relating to the amendment order. In order for me to compare the amendment order to the consolidation order, the latter would have to be in a form which reflects all the previous amendments.</p> <p>2. When looking at the consolidation order in conjunction with the No 6 amendment order, it is not possible to identify what the approved plans are. No description of the approved plans is included, merely a list of numbers referencing "map tiles". This makes the orders ineffective.</p>	<p>The Consolidation Order and all previous amendment orders are available to view by appointment at County Hall, Usk, along with the other deposited documents as required by legislation. In addition to this, we make the documents available on the MCC website. All relevant documents are available, allowing comparison between Amendment Orders to be made in order to see how the proposal will affect the existing orders.</p> <p>The drawings 1958, 1953 and 1952 were included within the online documents and are referenced in the proposed order in addition to being available to view at County Hall by prior appointment. These documents identify the specific amendments. Map tile references refer to individual tiles associated with the overarching consolidation that will be amended as part of the order making process. The correct procedure has been followed and all relevant documents were available to view as part of the consultation process.</p>

## Appendix 2:

### ROAD TRAFFIC REGULATION ACT 1984

#### NOTICE OF INTENTION TO MAKE A PERMANENT ORDER

**MONMOUTHSHIRE COUNTY COUNCIL  
MONMOUTHSHIRE COUNTY COUNCIL TRAFFIC REGULATION, SPEED LIMITS AND PARKING  
REGULATIONS CONSOLIDATION ORDER 2019  
(AMENDMENT ORDER NO 6) 2022**

**PROPOSED PROVISION AND AMENDMENTS TO TRAFFIC  
ORDERS WITHIN VARIOUS COMMUNITIES IN MONMOUTHSHIRE**

**NOTICE IS HEREBY GIVEN** that Monmouthshire County Council of County Hall, The Rhadyr, Usk, NP15 1GA ("the Council") propose to make a Road Traffic Regulation Order as follows:

**EFFECT OF THE ORDER:** to introduce and amend-

- a prohibition of driving (except for loading) restriction, Frogmore/Lion Street Abergavenny
- a motorcycle only parking area and provision for motorhomes, Abergavenny Bus Station
- Off street parking at Severn Tunnel Junction and Rogiet Countryside Park
- parking charges at Wyebridge Car Park, Monmouth and all long stay car parks
- provision for the enforcement of parking Electric Vehicle Only bays

within the localities identified on the plans, which are available to view at County Hall, Usk or online via <http://www.monmouthshire.gov.uk/public-consultation-traffic>

Further details of the proposed Order, comprising plans and a statement of reasons for proposing to make the Order may be examined via pre-arranged appointment at County Hall, Usk NP15 1GA (appointments can be arranged by e-mailing [traffic@monmouthshire.gov.uk](mailto:traffic@monmouthshire.gov.uk)) or by phoning 01633 644644 or online via <http://www.monmouthshire.gov.uk/public-consultation-traffic> or the via the below QR code

Any objections in respect of this proposal should be made in writing, stating the grounds on which the objection is being made and should be sent to Traffic Section, Monmouthshire County Council, County Hall, Usk NP15 1GA not later than 5 pm on Wednesday the 16<sup>th</sup> November 2022 or via scanning the QR code below and selecting "How to comment on a proposed TRO", where the public consultation response form can be accessed.



**Date: 26<sup>th</sup> October 2022**

**Mark Hand,  
Head of Placemaking, Regeneration, Highways and Flooding,  
Monmouthshire County Council**

## Appendix 3:

### STATEMENT OF REASONS

#### **1. Motorcycle Only Parking area, Abergavenny Bus Station**

Monmouthshire County Council has recently undertaken engineering works within the Bus Station and amended the bus station layout. In order to formalise an area for motorcycles to park within the revised bus station layout it is proposed to provide a dedicated motorcycle only parking area. This motorcycle only parking area is proposed to be situated in the vicinity of the Oasis Café which is patronised by the motorcyclists and other clients.

#### **2. Prohibition of Driving and Prohibition of Driving (Except for Loading), Frogmore Street and Lion Street, Abergavenny**

Monmouthshire County Council has previously undertaken works within Frogmore Street to alter the highway layout and to enhance the urban street scene experience for pedestrians and other highway users. In order to formalise and support the current usage of Frogmore Street it is necessary to prohibit driving on part of Frogmore Street and on part of Lion Street within a specified time period and to permit driving to undertake deliveries only within a specified time period only.



## Appendix 4: Drawings

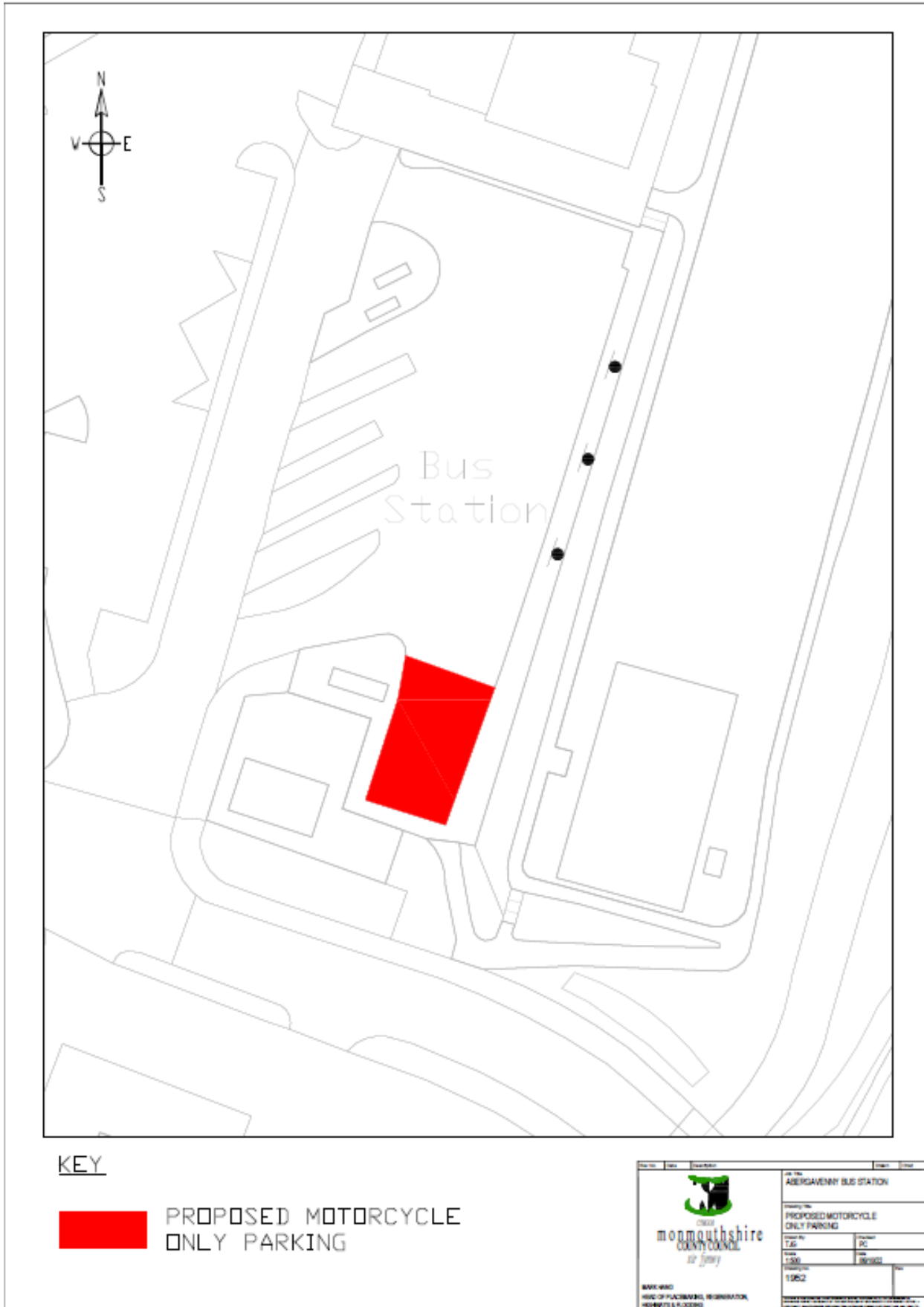

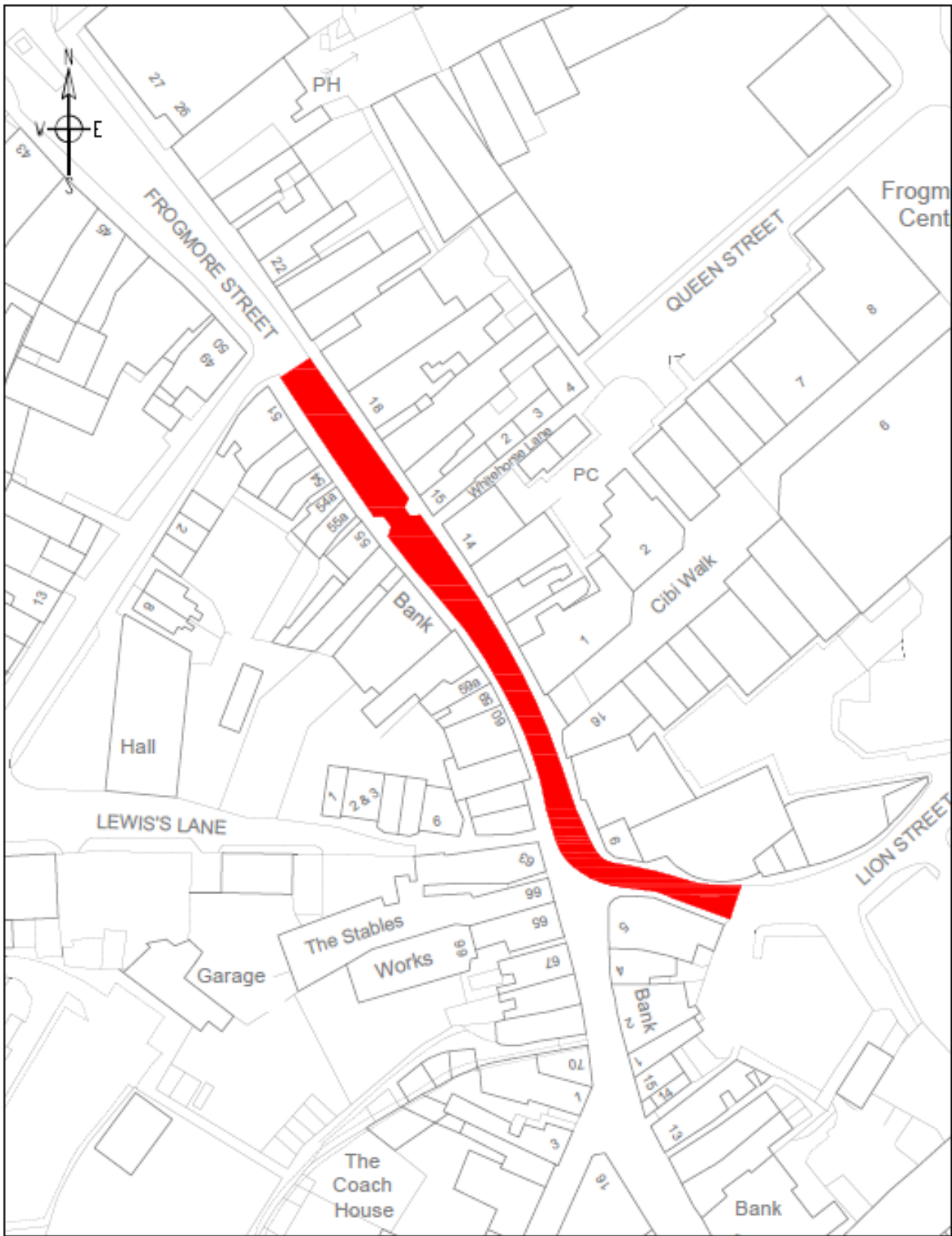

**KEY**

- PROPOSED PROHIBITION OF DRIVING 10AM TO 4PM, MONDAY TO SUNDAY
- PROPOSED PROHIBITION OF DRIVING (EXCEPT FOR LOADING) 4PM TO 10AM, MONDAY TO SUNDAY

 <b>monmouthshire</b> COUNTY COUNCIL <i>at large</i>		Title: THE FROGMORE STREET AND LION STREET ABERDARE Drawing No: PROPOSED PROHIBITION OF DRIVING Date: 1-1-2009 Drawing No: 1363	
NAME AND TITLE OF PLANNING PERMISSION NUMBER & ADDRESS		Author: PC Date: (Date) Scale:	

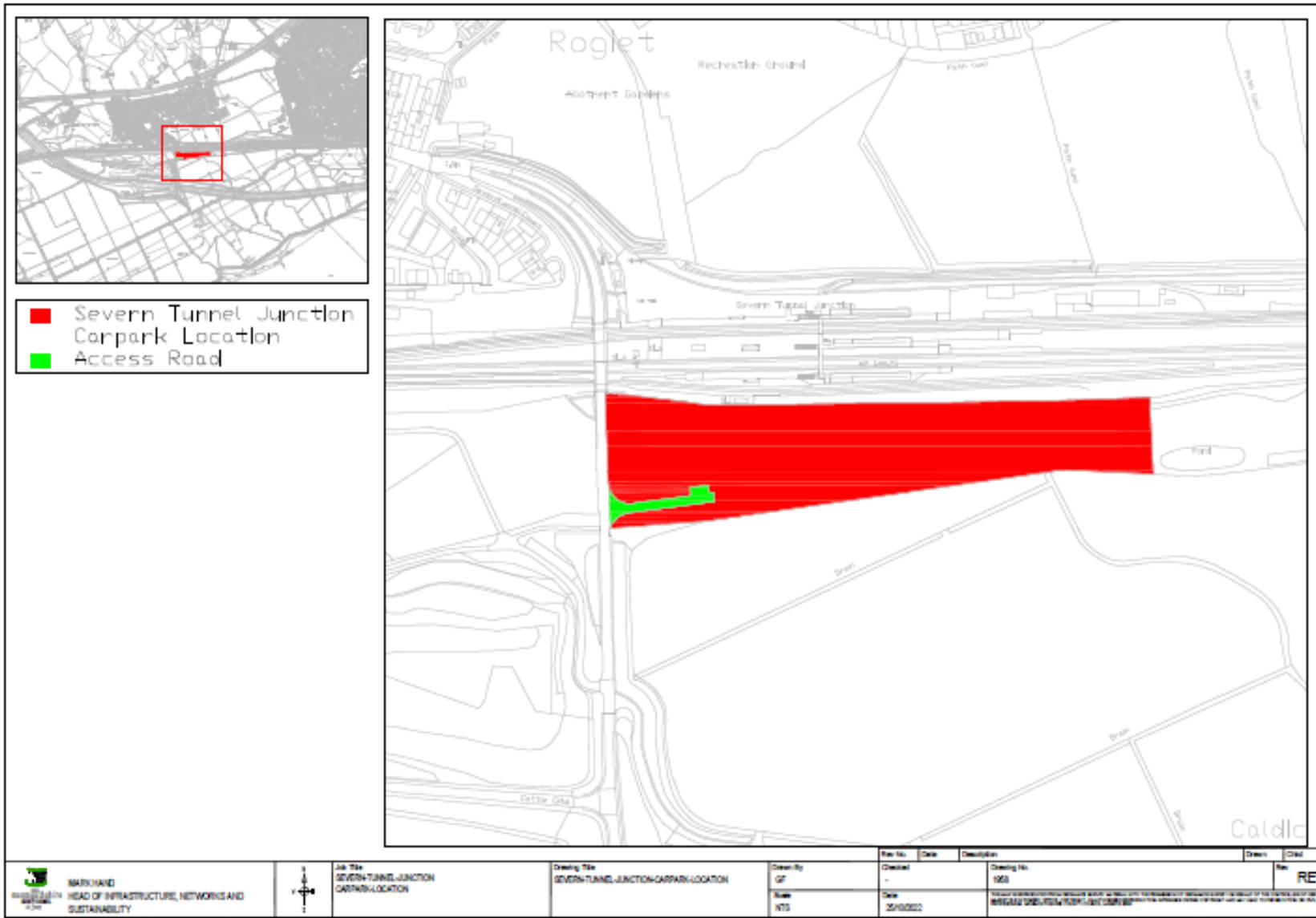



**monmouthshire**  
**sir fynwy**

## Equality and Future Generations Evaluation

<p><b>Name of the Officer</b> completing the evaluation</p> <p><b>Mark Hand</b>  <b>Phone no: 01633 644773</b>  <b>E-mail: <a href="mailto:markhand@monmouthshire.gov.uk">markhand@monmouthshire.gov.uk</a></b></p>	<p><b>Please give a brief description of the aims of the proposal</b></p> <p>To consider a number of Traffic Orders and variations to the car parking schedule – Amendment Order 6</p>
<p><b>Name of Service area</b></p> <p>Placemaking, Regeneration, Highways and Flooding</p>	<p><b>8<sup>th</sup> November 2022</b></p>

**1. Are your proposals going to affect any people or groups of people with protected characteristics?** Please explain the impact, the evidence you have used and any action you are taking below.

Protected Characteristics	Describe any positive impacts your proposal has on the protected characteristic	Describe any negative impacts your proposal has on the protected characteristic	What has been/will be done to mitigate any negative impacts or better contribute to positive impacts?
Age	Making the part time pedestrianisation of Frogmore Street and Lion Street, with loading only at other times, will benefit children and young people, parents and people with mobility difficulties by creating a safer car free environment.	On-street parking immediately outside business premises is not available.  Older people might be less likely to use the PaybyPhone app to extend their parking stay.	Blue badge holder parking provision has been increased in close proximity to the main shopping area, for example Tiverton Place car park.  A phone number is available for people to access PaybyPhone services without the need for an app.

<b>Protected Characteristics</b>	<b>Describe any positive impacts your proposal has on the protected characteristic</b>	<b>Describe any negative impacts your proposal has on the protected characteristic</b>	<b>What has been/will be done to mitigate any negative impacts or better contribute to positive impacts?</b>
Disability	<p>Introducing the specified car parks into the consolidation order will provide dedicated disabled persons parking places.</p> <p>Making the part time pedestrianisation of Frogmore Street and Lion Street, with loading only at other times, will benefit people with mobility difficulties and visual impairment by creating a safer car free environment.</p>	On-street parking immediately outside business premises is not available	Blue badge holder parking provision has been increased in close proximity to the main shopping area, for example Tiverton Place car park.
Gender reassignment	None	None	N/A
Marriage or civil partnership	None	None	N/A
Pregnancy or maternity	Making the part time pedestrianisation of Frogmore Street and Lion Street, with loading only at other times, will benefit expectant mothers and parents with children by creating a safer car free environment.	On-street parking immediately outside business premises is not available	The town benefits from several car parks in close proximity to the main shopping area.
Race	None	None	N/A
Religion or Belief	None	None	N/A
Sex	None	None	N/A
Sexual Orientation	None	None	N/A

## **The Socio-economic Duty and Social Justice**

**The Socio-economic Duty requires public bodies to have due regard to the need to reduce inequalities of outcome which result from socio-economic disadvantage when taking key decisions This duty aligns with our commitment as an authority to Social Justice.**

	<b>Describe any positive impacts your proposal has in respect of people suffering socio economic disadvantage</b>	<b>Describe any negative impacts your proposal has in respect of people suffering socio economic disadvantage.</b>	<b>What has been/will be done to mitigate any negative impacts or better contribute to positive impacts?</b>
<b>Socio-economic Duty and Social Justice</b>	Providing a traffic free environment in Abergavenny will allow visitors to feely use the public space available. Additionally, it will encourage businesses to expand into the public realm.	Introducing charging within car parks whilst allowing MCC to manage usage, may lead to sections of society being excluded from parking legally.	N/A

## Policy making and the Welsh language.

How does your proposal impact on the following aspects of the Council's Welsh Language Standards:	Describe the positive impacts of this proposal	Describe the negative impacts of this proposal	What has been/will be done to mitigate any negative impacts or better contribute to positive impacts
<p><b>Policy Making</b></p> <p>Effects on the use of the Welsh language,</p> <p>Promoting Welsh language</p> <p>Treating the Welsh language no less favourably</p>	<p>All new highway and car park signs and carriageway markings will be bi-lingual with Welsh appearing in front of English as per current guidance</p>	<p>None</p>	<p>N/A</p>
<p><b>Operational</b></p> <p>Recruitment &amp; Training of workforce</p>	<p>None</p>	<p>None</p>	<p>N/A</p>
<p><b>Service delivery</b></p> <p>Use of Welsh language in service delivery</p> <p>Promoting use of the language</p>	<p>All documents are available to view via pre booked appointment at County Hall, Usk and the plans and orders are published online. All relevant documents are published bilingually as well as signage and road markings.</p>	<p>None</p>	<p>N/A</p>

**4. Does your proposal deliver any of the well-being goals below?** Please explain the impact (positive and negative) you expect, together with suggestions of how to mitigate negative impacts or better contribute to the goal. There's no need to put something in every box if it is not relevant!





<b>Well Being Goal</b>	<b>Does the proposal contribute to this goal? Describe the positive and negative impacts.</b>	<b>What actions have been/will be taken to mitigate any negative impacts or better contribute to positive impacts?</b>
<p><b>A prosperous Wales</b> Efficient use of resources, skilled, educated people, generates wealth, provides jobs</p>	<p>Positive: Providing a traffic free environment in Abergavenny will encourage businesses to expand into the public realm.</p> <p>Allowing motorhome parking will support the visitor economy.</p>	N/A
<p><b>A resilient Wales</b> Maintain and enhance biodiversity and ecosystems that support resilience and can adapt to change (e.g. climate change)</p>	<p>Positive: Providing a traffic free environment in Abergavenny reduces noise and emissions within the main shopping area and allows space for planters. The new Severn Tunnel Junction Car Park will encourage the use of public transport. Managing electric vehicle parking bays will increase the opportunity for electric vehicle owners to charge their vehicle, which in turn may encourage people to purchase electric vehicles.</p>	N/A
<p><b>A Healthier Wales</b> People's physical and mental wellbeing is maximized and health impacts are understood</p>	<p>Positive: Providing a traffic free environment in Abergavenny reduces noise and emissions within the main shopping area.</p>	N/A
<p><b>A Wales of cohesive communities</b> Communities are attractive, viable, safe and well connected</p>	<p>Positive: providing additional parking places will lessen the impact of unregulated on street parking practices. Specifically the new Severn Tunnel Junction Car Park will encourage the use of public transport.</p>	N/A
<p><b>A globally responsible Wales</b> Taking account of impact on global well-being when considering local</p>	<p>Positive: The new Severn Tunnel Junction Car Park will encourage the use of public transport. Managing electric vehicle parking bays will increase the opportunity for electric vehicle</p>	N/A



Well Being Goal	Does the proposal contribute to this goal? Describe the positive and negative impacts.	What actions have been/will be taken to mitigate any negative impacts or better contribute to positive impacts?
social, economic and environmental wellbeing	owners to charge their vehicle, which in turn may encourage people to purchase electric vehicles.	
<b>A Wales of vibrant culture and thriving Welsh language</b> Culture, heritage and Welsh language are promoted and protected. People are encouraged to do sport, art and recreation	Neutral	N/A
<b>A more equal Wales</b> People can fulfil their potential no matter what their background or circumstances	Neutral	N/A

**3. How has your proposal embedded and prioritised the sustainable governance principles in its development?**

Sustainable Development Principle	Does your proposal demonstrate you have met this principle? If yes, describe how. If not explain why.	Are there any additional actions to be taken to mitigate any negative impacts or better contribute to positive impacts?
 Balancing short term need with long term and planning for the future	Managing electric vehicle parking bays will increase the opportunity for electric vehicle owners to charge their vehicle, which in turn may encourage people to purchase electric vehicles.	N/A

Sustainable Development Principle	Does your proposal demonstrate you have met this principle? If yes, describe how. If not explain why.	Are there any additional actions to be taken to mitigate any negative impacts or better contribute to positive impacts?
 <p>Working together with other partners to deliver objectives</p> <p><b>Collaboration</b></p>	<p>The proposals have been subject to consultation.</p> <p>The Orders support the visitor economy and local businesses for example by allowing motorhomes and motorcycles to park at the bus station, and by maintaining the car-free environment in the town centre during the core trading hours, with deliveries only outside those hours.</p>	N/A
 <p>Involving those with an interest and seeking their views</p> <p><b>Involvement</b></p>	<p>Statutory consultation has been undertaken with all necessary stakeholders including the general public.</p>	N/A
 <p>Putting resources into preventing problems occurring or getting worse</p> <p><b>Prevention</b></p>	<p>The proposals seek to increase off street parking provision within the county, which should reduce instances of inappropriate parking in residential streets.</p>	None
 <p>Considering impact on all wellbeing goals together and on other bodies</p> <p><b>Integration</b></p>	<p>The proposals consider the impacts on residents, businesses, public transport providers and emergency services.</p>	None

**4. Council has agreed the need to consider the impact its decisions has on the following important responsibilities: Social Justice, Corporate Parenting and Safeguarding. Are your proposals going to affect any of these responsibilities?**

	<b>Describe any positive impacts your proposal has</b>	<b>Describe any negative impacts your proposal has</b>	<b>What will you do/ have you done to mitigate any negative impacts or better contribute to positive impacts?</b>
Social Justice	N/A	N/A	N/A
Safeguarding	N/A	N/A	N/A
Corporate Parenting	N/A	N/A	N/A

**5. What evidence and data has informed the development of your proposal?**

- Officer observations and correspondence from the respective communities and their elected representatives.

**6. SUMMARY: As a result of completing this form, what are the main positive and negative impacts of your proposal, how have they informed/changed the development of the proposal so far and what will you be doing in future?**

**Positive impacts:** The proposals will encourage the use of off street parking areas and facilities, and encourage economic growth within Abergavenny town. Managing electric vehicle parking bays will increase the opportunity for electric vehicle owners to charge their vehicle, which in turn may encourage people to purchase electric vehicles. The STJ car park will encourage public transport use in an appropriately enforced car park.

**7. ACTIONS:** As a result of completing this form are there any further actions you will be undertaking? Please detail them below, if applicable.

<b>What are you going to do</b>	<b>When are you going to do it?</b>	<b>Who is responsible</b>
Implement the various proposals as consulted upon and advertised	Following the making and publication of the traffic regulation orders	Traffic and Car Parking Teams (Graham Kinsella, Phaedra Cleary, Gareth Freeman, Neil Rosser)

**8. VERSION CONTROL:** The Equality and Future Generations Evaluation should be used at the earliest stage, such as informally within your service, and then further developed throughout the decision making process. It is important to keep a record of this process to demonstrate how you have considered and built in equality and future generations considerations wherever possible.

<b>Version No.</b>	<b>Decision making stage</b>	<b>Date considered</b>	<b>Brief description of any amendments made following consideration</b>
1	ICMD decision post-consultation	Nov 2022	Review of impacts based on public consultation responses.
2			
3			